

Requires prior installation of Excel Life with Netatmo Gateway or Starter Kit:

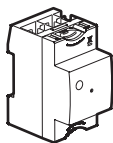

DIN-rail Gateway
(Cat no. 412181)

OR

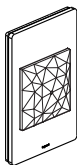

Starter kit
(EWNSKIT series)

Pack contents:

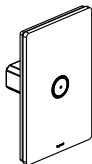

OR

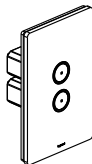

OR

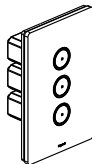

Smart dimmer 3 Wire

Characteristics

In default operating mode (on/off), this switch works with the following bulbs:

| | | | | | |
|-------------------------|----------------------------|-------|-----------|-------|-------|
| + 45°C + 5°C | 2 x 2.5mm ² | | LED | | |
| 100-240 VAC 50/60 Hz | | | | | |
| 240 VAC | Max. | 150 W | (* 150 W) | 150 W | 150 W |
| 100 VAC | Max. | 75 W | (* 75 W) | 75 W | 75 W |

(*) For a good light comfort, it is recommended to use bulbs of the same type and the same manufacturer.

In dimmer option operating mode (which can be activated via the App), this switch functions only with dimmable bulbs (identifiable by the logo on packaging). To be bench tested prior to installation.



Before you start: multi-way switching configuration



Do not use: two smart dimmers to control the same lighting point.

If you plan to install two-way light switches, read the following :

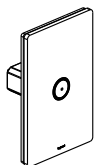

Smart dimmer
x1

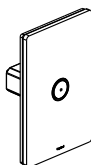

Smart dimmer
x1

AND

OR

AND

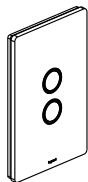

Wireless switch
x1 or more

EWNWSW1



EM770X

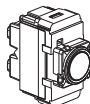

EM970BP or
EM970LBP



EM800SLAVE

Push-button
x 1 or more

Tip if replacing a two-way switch using a wireless switch:

old flush-mounted switch replaced by the wireless switch.

Use a connector (Cat no. 401 or equivalent) to connect Active and Switched Active wires.

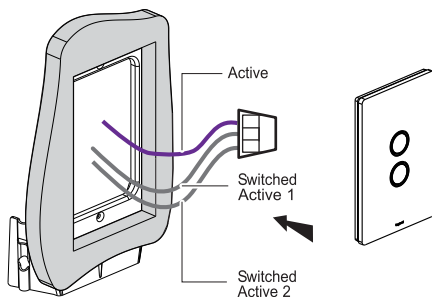

① Necessary safety precautions

①



OFF

Switch OFF the power at the main circuit breaker

②



Make sure that the power is OFF before continuing with the installation.

② Install the smart dimmer

① Remove the existing switch

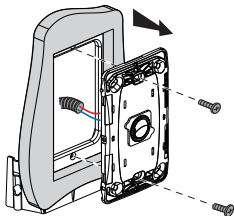

② Wire the smart dimmer:

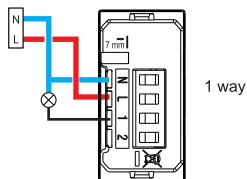

② Wire the smart dimmer

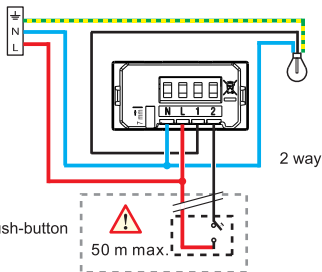

— N (neutral) = blue
— L (live) = any except blue and green/yellow

Note: Up to 20 push-buttons can be wired

③ Install the smart dimmer on the wall

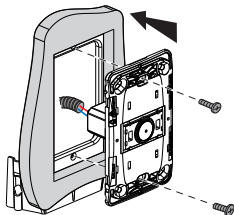

Frequency bands: 2.4 - 2.4835 GHz
Power level: < 100 mW



The smart dimmer works with standard or dimmable bulbs including LED. LED dimmable bulbs are mandatory for an optimal dimmer usage.



③ **To add a connected product to your connected installation, you should follow the instructions:**

- in the **user guide in your Starter kit**
- in the **Legrand Home + Control application (Settings/Add a new product section)**
- or consult the user manual on **<http://ecat.legrand.com.au/>**



Legrand - Australia 1300 369 777

www.legrand.com.au

Legrand - New Zealand 0800 476 009

www.legrand.co.nz

 **Safety instructions**

This product should be installed in compliance with installation rules, preferably by a qualified electrician. Incorrect installation and/or incorrect use can lead to risk of electric shock or fire. Before carrying out the installation, read the instructions and take account of the product's specific mounting location.

Do not open up, dismantle, alter or modify the device except where specifically required to do so by the instructions. All Legrand products must be opened and repaired exclusively by personnel trained and approved by Legrand. Any unauthorised opening or repair completely cancels all liabilities and the rights to replacement and guarantees. Use only Legrand brand accessories.

Warranty

Legrand Australia Pty Ltd warrants this product for a period of 12 months from the date of purchase. These goods come with guarantees that cannot be excluded under the Australian and New Zealand Consumer Laws. You are entitled to a replacement or a refund for a major failure and compensation for any other reasonably foreseeable loss or damage. You are also entitled to have the goods repaired or replaced if the goods fail to be of acceptable quality and the failure does not amount to a major failure.